



GUARDJOINT[®]
IMPACT-FREE ARMOURING



ISEDIO[®]
THE COMPETITIVE EDGE
IN CONCRETE FLOORING

TECHNICAL DATASHEET
GUARDJOINT FIXED Revision 7/11/2019

GUARDJOINT FIXED

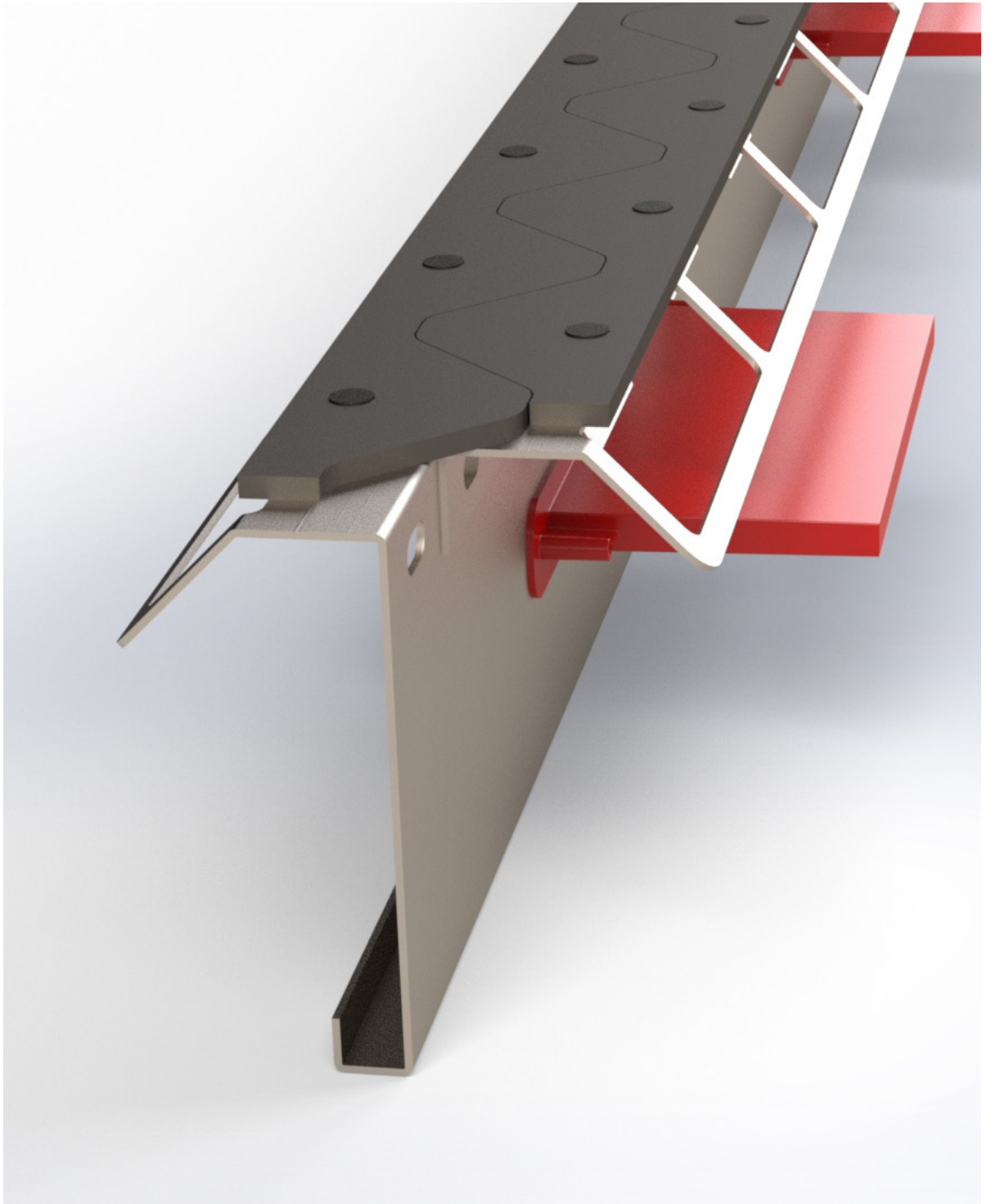

www.isedio.com

Isedio Limited. Unit 10 Jubilee Park, Badger's Cross Lane, Somerton, Somerset, TA11 7JF, UK.
T: +44 (0) 1458 270 600 E: info@isedio.com Registered in England and Wales: 07025519

Copyright © 2018 Isedio Limited. Errors and omissions excepted. Isedio Limited reserves the right to revise this documentation and to make changes in content from time to time without obligation on the part of Isedio Limited to provide notification of such revision or change. Information contained within this document is approximate.

PRODUCT DESCRIPTION & USES

GUARDJOINT FIXED is a leave-in-place formwork, load transfer and edge protection joint system suitable for heavy duty industrial concrete floors for joint openings up to a maximum of 15mm.

The joint system comprises two horizontal top plates with a wave geometry to eliminate impact when trafficked. Beneath the wave top plates are a divider plate, load transfer plate dowels and sleeves. The joint is designed such that once cast in-situ, as the two slab panels either side of the joint begin to cure and shrink, the joint separates such that one slab panel has the sleeve and one half top wave assembly and the other has the other half top wave assembly, divider plate and dowel. The dowel bridges across the joint and is embedded in both slab panels.

Formwork for casting a concrete slab is achieved by the vertical divider plate which supports the top strip edge protection and load transfer plate dowels.

Slab arris protection is provided by way of the top wave plates which create a seamless floor thus eliminating impact loads when traversed. The top wave plates are anchored to the concrete by perforated angled wings.

Load transfer across the joint is achieved by asymmetric plate dowels and sleeves. The plate dowels are attached to the vertical divider plate and the sleeves are held in place under friction and are detachable as the joint opens up.

MATERIAL SPECIFICATION

COMPONENT	MATERIAL
TOP PLATES	HOT ROLLED (CAN BE SUPPLIED IN STAINLESS STEEL OR HOT DIP GALVANISED)
FRANGIBLE FASTENER	NYLON
DIVIDER PLATE	STEEL DC01 TO BS EN 10130:2006
LOAD TRANSFER DOWEL PLATE	6MM - S275 STEEL 8MM & 12MM - S355 STEEL TO BS EN 10025-2:2004
SLEEVE	6MM, 8MM & 12MM - PP

TECHNICAL DATA

DESCRIPTION	DIMENSION & TOLERANCE
JOINT LENGTH	2875MM +/-2.0MM
MAX JOINT OPENING	15MM
STRAIGHTNESS	+/-0.5MM IN 600MM
GENERAL DIMENSIONAL TOLERANCE	DIMENSIONS < 12MM +/-0.5MM DIMENSIONS > 12MM +/-2.0MM

Information on load transfer capacities can be found on the Load Transfer Capacity Datasheet.

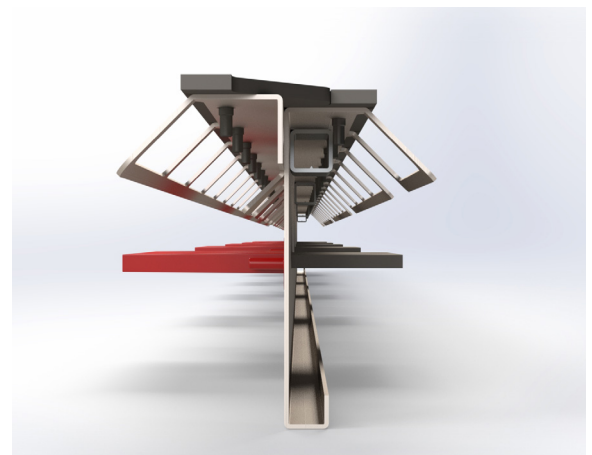
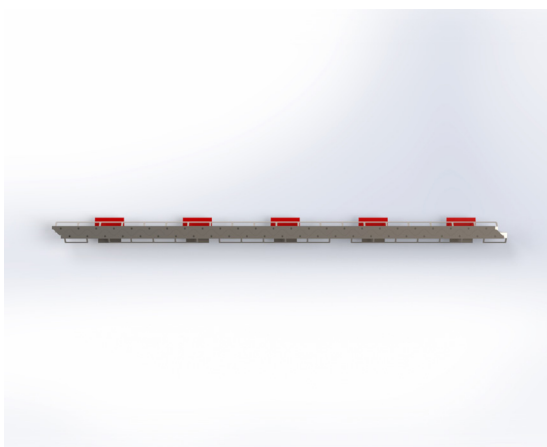
PLAN AND END VIEW IMAGES

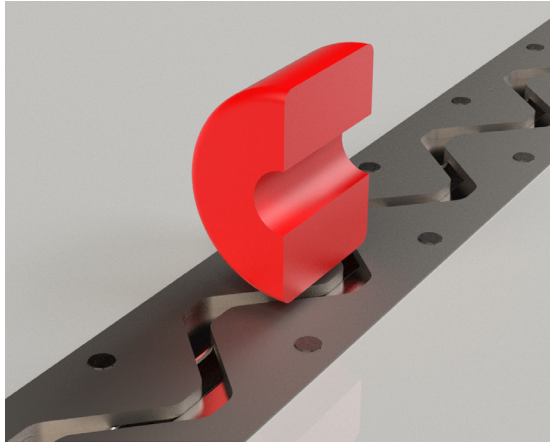
ZERO IMPACT

GUARDJOINT eliminates impact across the joint from Mechanical Handling Equipment (MHE) such as forklift trucks. The shape of the wave is engineered such that even the smallest pallet wheeled trucks do not cause an impact.

GUARDJOINT is an excellent solution for high traffic areas such as loading docks, doorways or VNA aisles (non-wire guided) where a transitionless floor is required. It is capable of a maximum joint opening of 15mm. By installing GUARDJOINT a floor can be future-proofed for other possible end uses.

If a sealant free/sealed floor is required please refer to our SHIELDJOINT system.

PACKAGING INFORMATION
5 X 6MM DOWELS (575MM CENTRES)

JOINT (MM)	QTY & METRES OF JOINT PER BUNDLE	APPROX BUNDLE WEIGHT INC PACKAGING (KG)	MAX NO OF BUNDLES & METRES PER TRUCK
100MM	55 OFF - 158.1M	1726 KG	14 BUNDLES - 2213.7M
130MM	55 OFF - 158.1M	1782 KG	13 BUNDLES - 2055.6M
150MM	44 OFF - 126.5M	1475 KG	16 BUNDLES - 2024.0M
200MM	33 OFF - 94.9M	1187 KG	16 BUNDLES - 1518.0M
250MM	33 OFF - 94.9M	1336 KG	16 BUNDLES - 1518.0M

5 X 8MM DOWELS (575MM CENTRES)

JOINT (MM)	QTY & METRES OF JOINT PER BUNDLE	APPROX BUNDLE WEIGHT INC PACKAGING (KG)	MAX NO OF BUNDLES & METRES PER TRUCK
100MM	55 OFF - 158.1M	1822 KG	13 BUNDLES - 2055.6M
130MM	55 OFF - 158.1M	1878 KG	12 BUNDLES - 1897.5M
150MM	44 OFF - 126.5M	1552 KG	15 BUNDLES - 1897.5M
200MM	33 OFF - 94.9M	1245 KG	16 BUNDLES - 1518.0M
250MM	33 OFF - 94.9M	1394 KG	16 BUNDLES - 1518.0M

5 X 12MM DOWELS (575MM CENTRES)

JOINT (MM)	QTY & METRES OF JOINT PER BUNDLE	APPROX BUNDLE WEIGHT INC PACKAGING (KG)	MAX NO OF BUNDLES & METRES PER TRUCK
100MM	55 OFF - 158.1M	2014 KG	12 BUNDLES - 1897.5M
130MM	55 OFF - 158.1M	2070 KG	11 BUNDLES - 1739.4M
150MM	44 OFF - 126.5M	1706 KG	14 BUNDLES - 1771.0M
200MM	33 OFF - 94.9M	1360 KG	16 BUNDLES - 1518.0M
250MM	33 OFF - 94.9M	1509 KG	16 BUNDLES - 1518.0M